

DESCRIPTION

Solenoid valve 3 way direct acting poppet type.
 The balanced seal and the special construction allows a big flow.
 The solenoid valve can be used as normally closed, normally open, mixer or diverter.



CONSTRUCTION

Body	Anodized aluminium
Armature tube	Stainless steel
Plunger and core	Stainless steel
Springs	Stainless steel
Seal	FPM

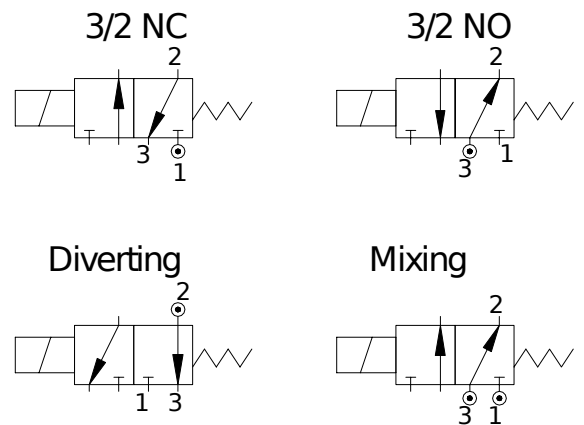

3

FEATURES

Maximum allowable pressure : 15 bar
 Maximum fluid viscosity 25cSt (mm²/s)
 Ambient temperature : -10°C +80°C
 Universal mounting position

OPTIONS : Special version for higher differential pressure

CODE	Connection G ISO 228	Orifice mm	KV m ³ /h	Differential pressure bar			Nominal power			Coil		Seal	Temp. range °C
				Min	Max		AC Inrush	VA Holding	DC Watt	Series	Width		
					AC	DC							
E320BV75///.....	1/4"	7.5	0.64	0	5	-	40	30	-	5	36	FPM=V	-10 +130
D320BV75///.....	1/4"	7.5	0.64	0	-	5	-	-	27	5	36		

② Coil

Example: E320BV75///52E FPM seal Coil 230V 50-60Hz

COILS	Alternating Current ~50/60Hz Volt							Direct Current Volt			Electrical connection	Connectors
	12	24	48	110	220 230	240	380	12	24	48		
Series 5 Width 36 Code ②	52A	52B	52C	52D	52E	52F	52G	520	521	522	DIN 43650A	PG11 code 10349001

DESCRIPTION
 Class H insulation
 Voltage tolerance
 AC +15% -10%
 DC ±10%
 Protection class
 IP65 with connector fitted
 IP00 without connector
 Continuous service ED100%

OPTIONS
 Cable attached
 Special coil powers
 Special coil voltages

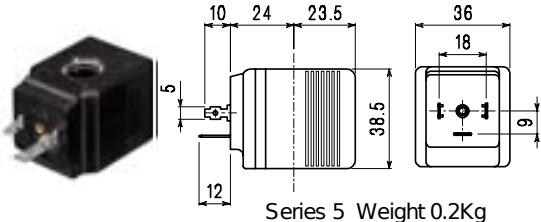

Series 5 Weight 0.2Kg

SPARE PARTS LIST

1. Coil fixing nut
2. Coil
3. Armature tube with core

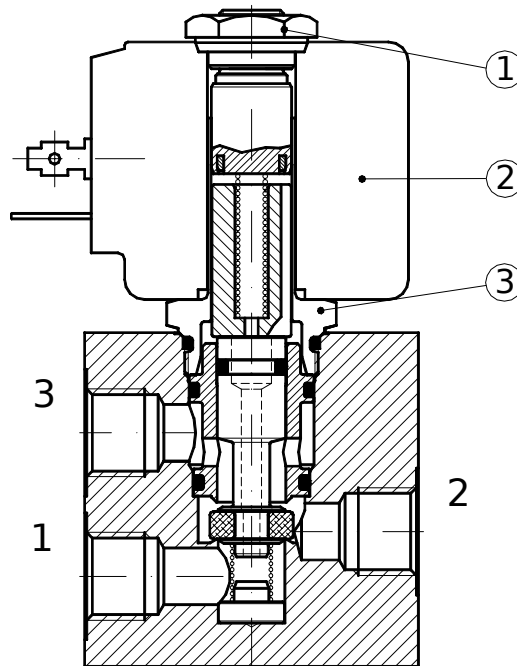

OVERALL DIMENSION

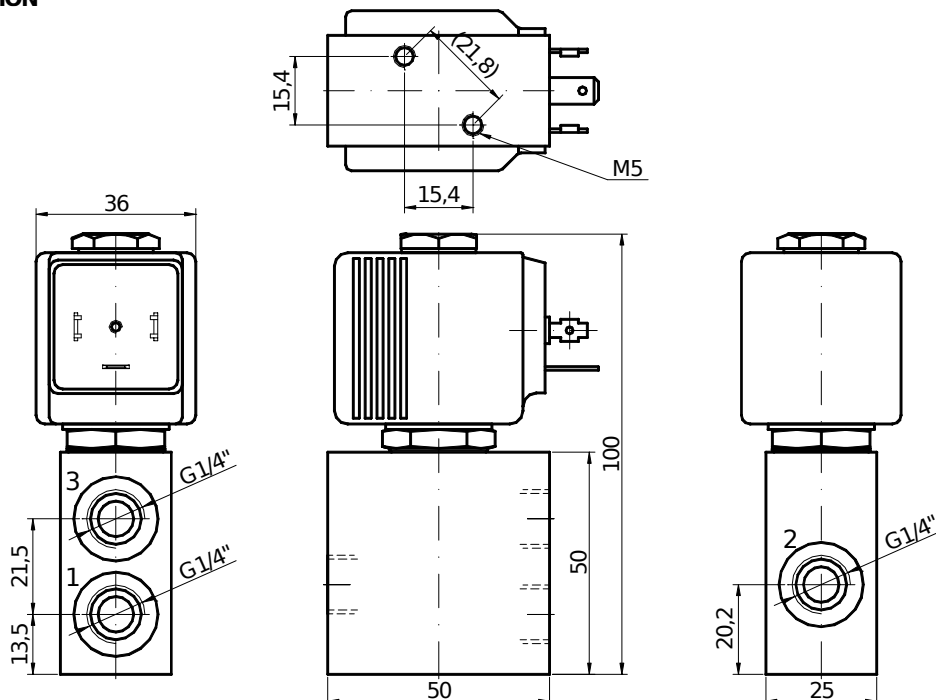

Weight = 0.43 Kg